

## Specifications

Rated Voltage	6V	
Nominal Capacity	7.2Ah	(C <sub>20</sub> , 1.75V/cell)
Dimension	Length	151±2mm (5.94 inches)
	Width	34±1mm (1.34 inches)
	Container Height	94±1mm (3.70 inches)
	Total Height	100±2mm (3.94 inches)
Approx Weight	1.05 Kg (2.31 lbs)	
Terminal	T1/T2	
Container Material	ABS	
Rated Capacity (25°C)	7.20 Ah	(20hr, 0.360A, 1.75V/cell)
	6.69 Ah	(10hr, 0.669A, 1.75V/cell)
	6.20 Ah	(5hr, 1.22A, 1.75V/cell)
	5.61 Ah	(3hr, 1.87A, 1.75V/cell)
	4.67 Ah	(1hr, 4.67A, 1.60V/cell)
Max. Discharge Current	108A (5s)	
Internal Resistance (25°C)	Approx 13mΩ	
Operating Temp. Range	Discharge	-15 ~ 50°C (5 ~ 122°F)
	Charge	0 ~ 40°C (32 ~ 104°F)
	Storage	-15 ~ 40°C (5 ~ 104°F)
Nominal Operating Temp. Range	25±3°C (77±5°F)	
Cycle Use	Initial Charging Current less than 2.16A. Voltage 7.2V~7.5V at 25°C(77°F)Temp. Coefficient -15mV/°C	
	Standby Use	
Effect of temp. to Capacity	Initial Charging Current less than 2.16A. Voltage 6.75V~6.9V at 25°C(77°F)Temp. Coefficient -10mV/°C	
	40°C (104°F)	103%
	25°C (77°F)	100%
Self Discharge	0°C (32°F)	86%
	Batteries may be stored for up to 6 months at 25°C(77°F) and then a freshening charge is required. For higher temperatures the time interval will be shorter.	

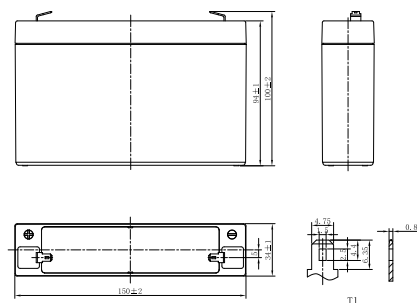

## Layout



## Constant Current Discharge (Amperes) at 25 °C (77°F)

F.V/Time	5min	10min	15min	20min	30min	45min	1h	1.5h	2h	3h	4h	5h	6h	8h	10h	20h
1.85V/cell	20.1	14.8	11.7	9.58	7.03	5.23	4.28	3.12	2.48	1.81	1.43	1.19	1.02	0.799	0.653	0.351
1.80V/cell	21.8	15.6	12.2	9.88	7.21	5.34	4.35	3.17	2.52	1.84	1.45	1.21	1.03	0.809	0.660	0.355
1.75V/cell	23.6	16.3	12.7	10.2	7.38	5.44	4.43	3.23	2.56	1.87	1.47	1.22	1.04	0.819	0.669	0.360
1.70V/cell	25.4	17.1	13.1	10.5	7.54	5.54	4.51	3.28	2.60	1.89	1.49	1.24	1.06	0.829	0.676	0.362
1.67V/cell	26.4	17.5	13.4	10.7	7.65	5.61	4.56	3.31	2.62	1.91	1.50	1.25	1.07	0.836	0.681	0.365
1.60V/cell	28.8	18.6	14.0	11.1	7.88	5.76	4.67	3.38	2.68	1.95	1.53	1.27	1.08	0.849	0.692	0.370

## Constant Power Discharge (Watts/cell) at 25 °C (77°F)

F.V/Time	5min	10min	15min	20min	30min	45min	1h	1.5h	2h	3h	4h	5h	6h	8h	10h	20h
1.85V/cell	38.2	28.3	22.6	18.4	13.6	10.1	8.32	6.10	4.86	3.56	2.82	2.35	2.01	1.59	1.30	0.703
1.80V/cell	41.2	29.6	23.3	18.9	13.9	10.3	8.44	6.18	4.92	3.61	2.85	2.38	2.04	1.60	1.31	0.710
1.75V/cell	44.2	30.9	24.0	19.4	14.1	10.5	8.57	6.26	4.98	3.65	2.89	2.40	2.06	1.62	1.33	0.717
1.70V/cell	47.2	32.1	24.8	19.9	14.4	10.6	8.69	6.35	5.05	3.70	2.92	2.43	2.08	1.64	1.34	0.725
1.67V/cell	49.0	32.9	25.2	20.2	14.6	10.7	8.76	6.40	5.09	3.73	2.94	2.45	2.10	1.65	1.35	0.729
1.60V/cell	52.9	34.6	26.2	20.8	14.9	11.0	8.93	6.51	5.17	3.79	2.99	2.49	2.13	1.68	1.37	0.740

# LP Series-General Purpose LP6-7.2(6V7.2Ah)

## Applications

- All purpose
- Uninterruptable Power Supply (UPS)
- Electric Power System (EPS)
- Emergency backup power supply
- Alarm and security system
- Communication power supply
- DC power supply
- Auto control system

## General Features

- 5 years design life(25°C)
- Special exhaust structure and sealing technology, safe and reliable, flexible installation, convenient maintenance
- PbCaSn alloy for plate grids: less gassing, less self-discharging
- High quality AGM separator: extend cycle life and prevent micro short circuit
- High purity raw material: ensure low self discharge rate

## Standards

- Compliance with IEC 60896 standards, EU Battery Directive
- UL, CE Certified
- Manufactured in Leoch® IATF 16949, ISO45001, ISO 9001 and ISO 14001 certified production facilities

## Discharge Characteristics

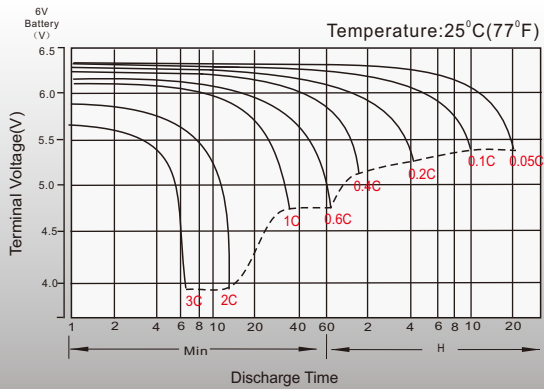

## Float Charging Characteristics

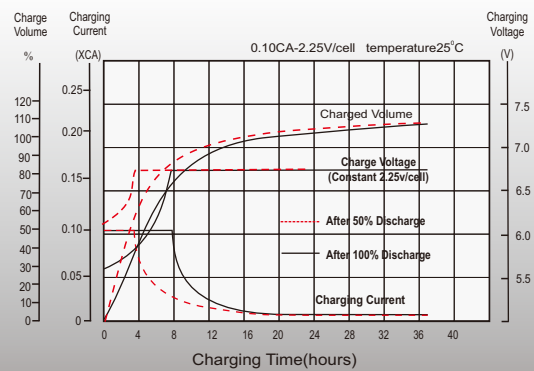

## Temperature Effects in Relation to Battery Capacity

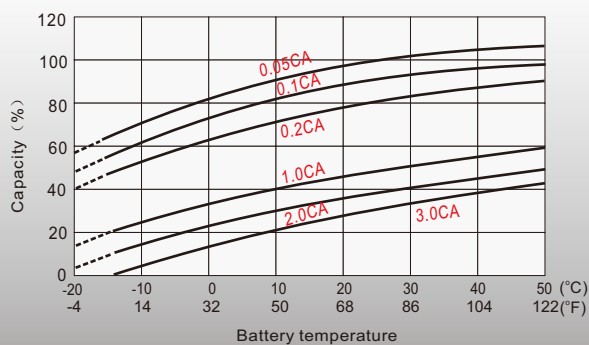

## Float Service Life

